

ESZ - TYPE Z STAIR BEARING FOR STRUCTURE-BORNE NOISE INSULATION IN BUILDUNG CONSTRUCTION

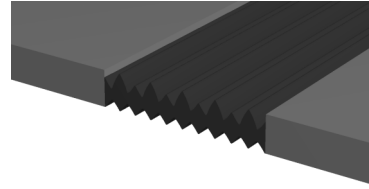

WILFRIED BECKER GMBH
Elastomer Service Zentrale

Weilerhöfe 1
41564 Kaarst-Büttgen

Telefon (0 21 31) 75 81 00
Telefax (0 21 31) 75 81 11

E-Mail: info@esz-becker.de
Internet: www.esz-becker.de

Profile bearing , t = 10 mm
ESZell as permanent formwork
with Building Authority Test Certificate Nr.: **A 13-BvL-2004**

INSTALLATION INSTRUCTIONS

1

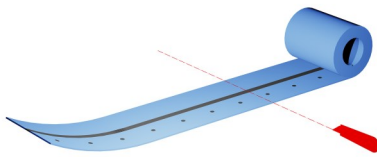

Unroll the rolled product and cut to the required length.

2

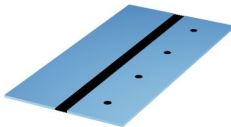

3

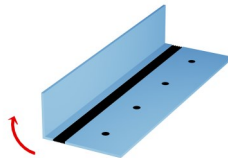

4

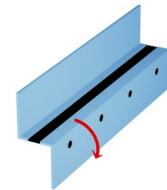

Bend the foam material at the desired bending edge (depending on the support depth)

5

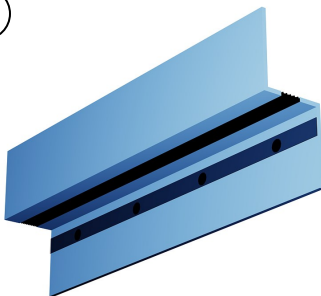

Peel off the protective film of the double-sided adhesive tape on the rear side of the spacer and firmly press the adhesive surface against the face of the support.

6

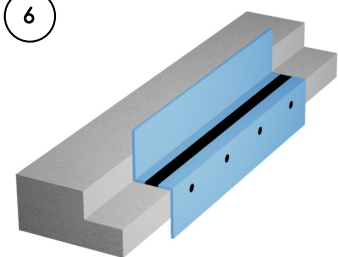

Place the bearing on the support. The support surface and the face must be free from grease, oil, dirt and loose particles.

7

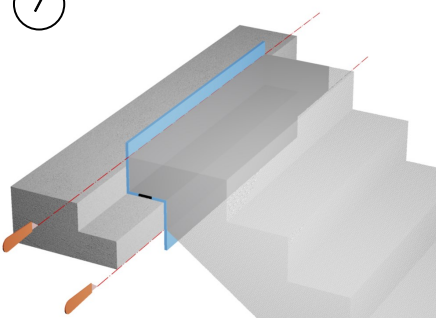

Place the flight of stairs on top and cut off the excess permanent formwork.

ESZ - TYPE Z STAIR BEARING FOR STRUCTURE-BORNE NOISE INSULATION IN BUILDUNG CONSTRUCTION

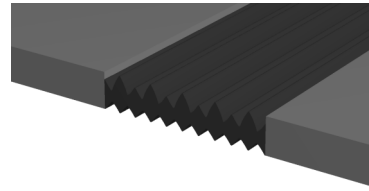

WILFRIED BECKER GMBH
Elastomer Service Zentrale

Weilerhöfe 1
41564 Kaarst-Büttgen

Telefon (0 21 31) 75 81 00
Telefax (0 21 31) 75 81 11

E-Mail: info@esz-becker.de
Internet: www.esz-becker.de

Profile bearing , t = 10 mm
ESZell as permanent formwork
with Building Authority Test Certificate Nr.: A 13-BvL-2004

INSTALLATION INSTRUCTIONS FOR CAST-IN-SITU STAIRS

In order to achieve additional protection against contamination in the component joint between the landing and the flight of stairs, the bearing can also be installed with lateral flaps. This method also makes an in-situ concrete execution possible. To do this, carry out steps 1 to 6 of the above instructions and additionally steps 7 to 10.

7

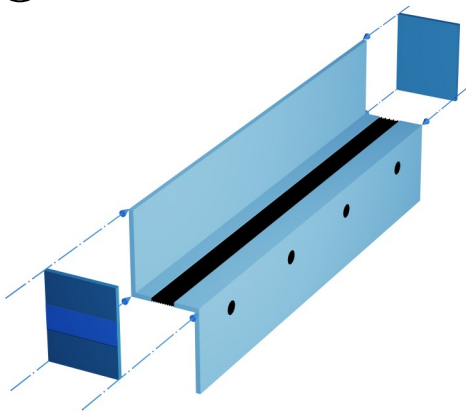

8

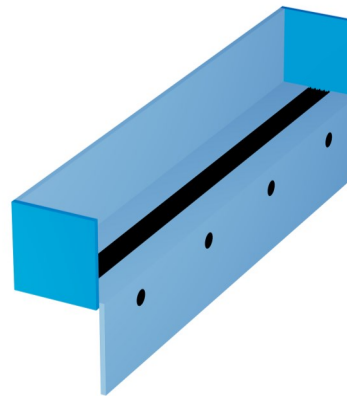

9

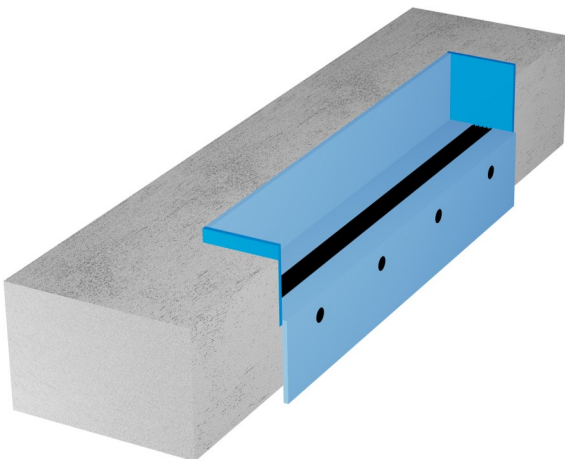

10

